

RoHS
COMPLIANT

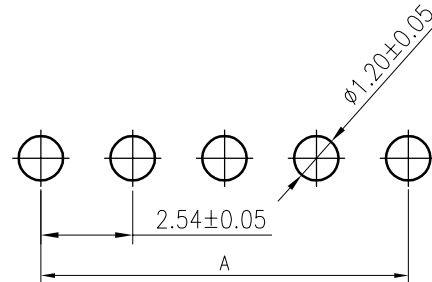

P.C.B LAYOUT

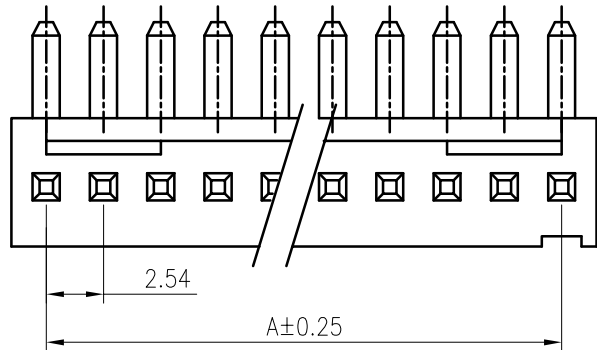
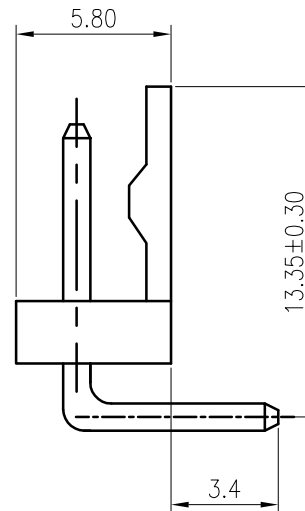
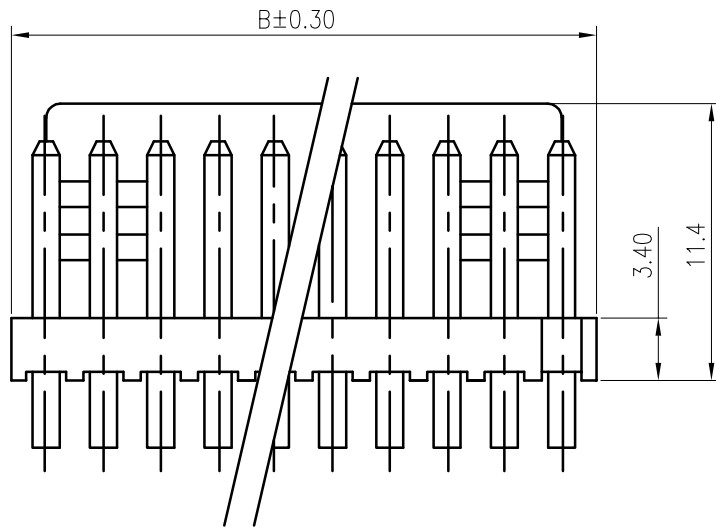

SPECIFICATIONS

1. Current rating: 4A AC, DC
2. Voltage rating: 250V AC,DC
3. Temperature range: -40°C ~ +105°C
4. Insulation resistance: 1000MΩ Min.
5. Withstanding voltage: 1000V AC/ minute.
6. Contact resistance: 10mΩ Max.

Material:

Insulator: PA66 UL 94V-0

Contact: Brass

Plating: Tin plated over Nickel

Mate with KR2540 series Housing

Ordering Code:

C2540RD *** 22 T01 01 PA

No.of Circuits

102:2,115:15

Circuits	Dimensions		Circuits	Dimensions	
	A	B		A	B
2	2.54	5.08	12	27.94	30.48
3	5.08	7.62	13	30.48	33.02
4	7.62	10.16	14	33.02	35.56
5	10.16	12.70	15	35.56	38.10
6	12.70	15.24	16	38.10	40.64
7	15.24	17.78	17	40.64	43.18
8	17.78	20.32	18	43.18	45.72
9	20.32	22.86	19	45.72	48.26
10	22.86	25.40	20	48.26	48.26
11	25.40	27.94			

TOLERANCE

X. X ±0.30

X. XX ±0.20

X. XXX ±0.10

Angle ±2°

TITLE:
MX2510 DIP 90°
Wafer 右弯

DRAWN: Arvin 2020.5.12

CHECKED:

APPROVED:

东莞市腾兴电子有限公司

PART NO. : C2540RD***22T0101PA



更改料号及图框格式

Arvin

2020.05.12

MARK

1

2

3

4

5

6

7

8

9

UNIT: mm

SCALE: N/A

SHEET: 1/1

PROJECTION

REV. : A2

DRAWING NO. : 2540WRD101-A-S