

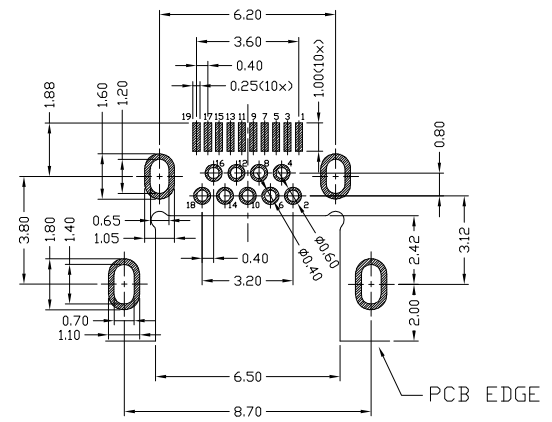

RoHS
Compliant
2002/95/EC

REV.	ECN. NO.	APPD.

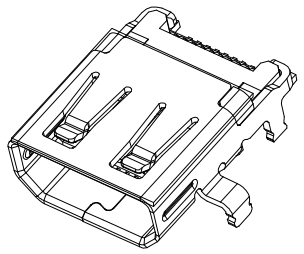
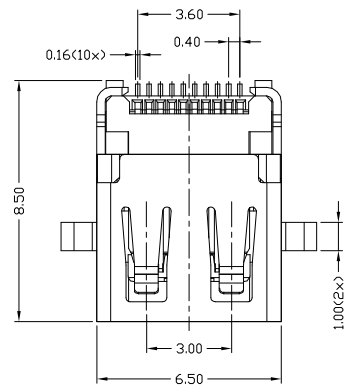

RECOMMENDED PCB LAYOUT(T=0.90mm)
TOLERANCE UNSPECIFIED ±0.05mm

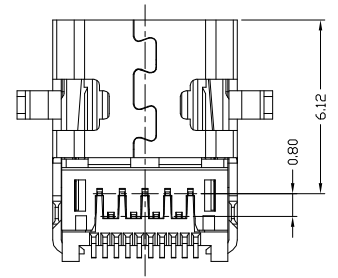
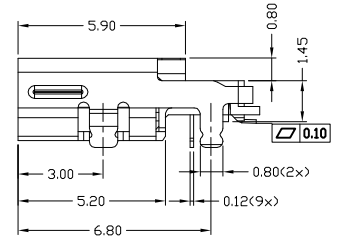
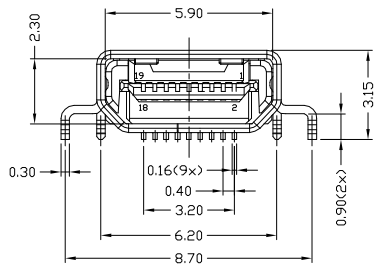

NOTES:

- ELECTRICAL:
 - VOLTAGE CURRENT RATING: 0.5AMP,30V AC;
 - INSULATION RESISTANCE: 100MΩ MIN;
 - CONTACT RESISTANCE: 30mΩ MAX;
 - WITHSTANDING VOLTAGE: 500V AC;
 - OPERATING TEMPERATURE:-55°C TO +105°C.
- Mechanical:
 - Mating Force: 35N MAX
 - Unmating Force: 10N MIN.
- DIMENSIONS MARKED "▼" TO BE CHECKED BY Q.C & IPQC.

4.PART NO.

HMDF-191N-4BHS40
 N: Ni
 G: Au
 1: Au 1U"
 5: Au 15U"

Bill of materials:

NO	PARTS	MATERIAL	QTY	FINISHING	UNITS	mm	东莞市腾兴电子有限公司				
3	HOUSING	LCP+30%GF	1	UL94V-0	X. ±0.35	X.' ±2'	MAT'L	TITLE: HDMI D TYPE F 沉板 H2.25 前插后贴		PART NO.: HMDF-191N-4BHS40	
2	SHELL	STAINLESS STEEL	1	PLATED NICKEL	.X ±0.3	.X' ±1'					
1	TERMINAL	COPPER ALLOY	19	PLATED GOLD/TIN	.XX ±0.25	.XX'	FINISH	DR:	2017/07/2		
					.XXX ±0.15	.XXX'	SEE NOTE	CHKD:	2017/07/2		
					<small>THESE DRAWINGS AND SPECIFICATIONS ARE THE PROPERTY OF ACCURATE INNOTECH INC AND SHALL NOT BE REPRODUCED, COPIED OR USED IN ANY MANNER WITHOUT THE PRIOR WRITTEN CONSENT OF ACCURATE INNOTECH INC.</small>		Q'TY	APPD:	2017/07/2		
								SCALE	SHEET	REV.	CUSTOMER DRAWING
								1:1	1/1	B	