

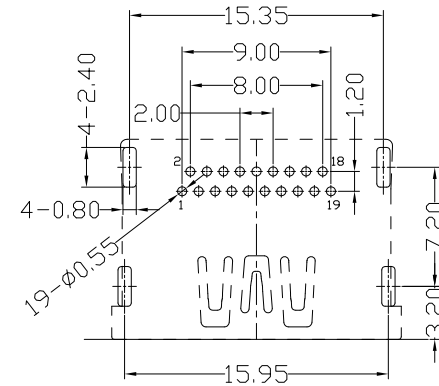

RoHS
Compliant
2002/95/EC

REV.	ECN. NO.	APPD.

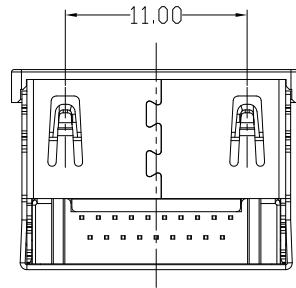
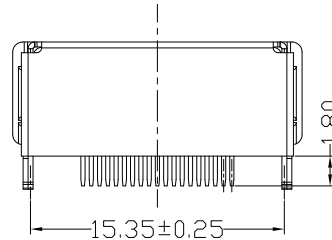
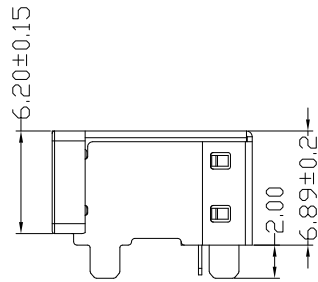
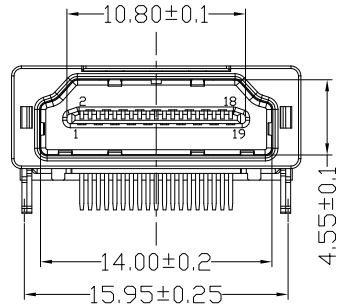
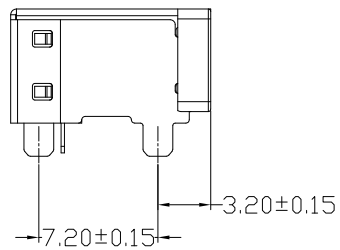
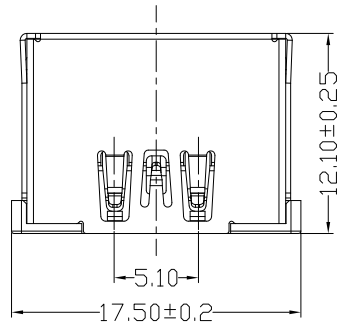

RECOMMENDED PCB LAYOUT

NOTES:

- ELECTRICAL:
 - VOLTAGE CURRENT RATING: 0.5AMP,30V AC;
 - INSULATION RESISTANCE: 1000MΩ MIN;
 - CONTACT RESISTANCE: 30mΩ MAX;
 - WITHSTANDING VOLTAGE: 500V AC;
 - OPERATING TEMPERATURE:-55°C TO +105°C.
- Mechanical:
 - Mating Force: 35N MAX
 - Unmating Force: 10N MIN.
- DIMENSIONS MARKED "▼" TO BE CHECKED BY Q.C & IPQC.

4.PART NO.

- HMAF-19*N-4BRA0
- 1:Au 1U"
 - 5:Au 15U"
 - 6:Au 30U"
 - W:WHITE
 - B:BLACK
 - 1:PBT
 - 2:PA6T
 - 3:PA9T
 - 4:LCP

Bill of materials:

E	3	HOUSING	LCP+30%GF	1	UL94V-0	X. ±0.35	X.' ±2'	UNITS	mm	东莞市腾兴电子有限公司				
	2	SHELL	STAINLESS STEEL	1	PLATED NICKEL	.X ±0.3	.X' ±1'	MAT'L						SEE NOTE
	1	TERMINAL	COPPER ALLOY	19	PLATED GOLD/TIN	.XX ±0.25	.XX'	FINISH	SEE NOTE	TITLE:	PART NO.:			
	NO	PARTS	MATERIAL	QTY	FINISHING	.XXX ±0.15	.XXX'	Q'TY	SEE NOTE	HDMI AF 19PIN DIP 反向全包式	HMAF-19XN-4BRA0			
						THESE DRAWINGS AND SPECIFICATIONS ARE THE PROPERTY OF ACCURATE INNOTECH INC AND SHALL NOT BE REPRODUCED, COPIED OR USED IN ANY MANNER WITHOUT THE PRIOR WRITTEN CONSENT OF ACCURATE INNOTECH INC.			DR:	Ricky 2019/02/14	DWG NO.:			
									CHKD:	Ricky 2019/02/14	SCALE	SHEET	REV.	CUSTOMER DRAWING
									APPD:		1:1	1/1	B	